



HEAR and LEARN
CLASSROOM SOUND ENHANCEMENT



975

Instructional Audio System

User Manual



hearandlearn.com.au

975 Point to Pair is part of the Hear and Learn technology family.
Offices Australia wide (03)93709355

Table of Contents

OVERVIEW

- 3** Important Safety Instructions
- 4** System Components and Unpacking
- 5** Optional Components
- 6** Optional Speakers
- 7** 975 Controls and Indicators
- 9** Flexmike Controls and Connections
- 10** Microphone Cradle Charger

SET-UP & OPERATION

- 11** Connecting the Power Supply
- 12** Setting Up the Flexmike
- 13** Charging the Flexmike
- 14** Daily Use of the Flexmike
- 15** Pairing your Microphone
- 16** Using the Life Safety Functions
- 18** Output Audio to Assistive Listening Device (ALD)
- 19** Using Your Microphone as a Wireless Audio Link
- 20** Audio Integration

OPTIONAL COMPONENTS

- 21** Sharemike Controls and Connections
- 24** Media Connector Controls and Indicators
- 26** Media Connector Set Up and Operation
- 27** Connecting Media Connector to Audio
- 28** Pairing 975 to Media Connector
- 29** Activate System with Pods

MAINTENANCE & TROUBLESHOOTING

- 30** Flexmike Battery Replacement
- 31** Sharemike Battery Replacement
- 32** Troubleshooting
- 33** Tips for Optimum Audio Performance

WARRANTY, SAFETY & SPECIFICATIONS

- 34** Five-Year Limited Warranty
- 35** Safety Warnings and Certifications
- 40** System Components
- 41** System Specifications

OVERVIEW

Important Safety Instructions

1. Do not use the apparatus near water.
2. Clean only with dry cloth.
3. Do not block any ventilation openings.
4. Do not install near any heat sources such as radiators, heat registers, stoves, or other apparatus (including amplifiers) that produce heat.
5. Do not defeat the safety purpose of the polarized or grounding-type plug. A polarized plug has two blades with one wider than the other. A grounding-type plug has two blades and a third grounding prong. The wide blade or the third prong is provided for your safety. If the provided plug does not fit into your outlet, consult an electrician for replacement of the outlet.
6. Protect the power cord from being walked on or pinched particularly at plugs, convenience receptacles, and the point where they exit from the apparatus.
7. Unplug this apparatus during lightning storms or when unused for long periods of time.
8. Refer all servicing to qualified service personnel. Servicing is required when the apparatus has been damaged in any way, such as power-supply cord or plug is damaged, liquid has been spilled or objects have fallen into the apparatus, the apparatus has been exposed to rain or moisture, does not operate normally, or has been dropped.
9. When the mains plug or appliance coupler is used as the disconnect device, it shall remain readily operable.
10. Please keep the unit in a good ventilation environment.
11. WARNING: To reduce the risk of fire or electric shock, do not expose this apparatus to rain or moisture.
12. Apparatus shall not be exposed to dripping or splashing and no objects filled with liquids, such as vases, shall be placed on the apparatus.
13. WARNING: Battery pack shall not be exposed to excessive heat such as sunshine, fire or the like. (1) The battery pack is not serviceable. Do not open, disassemble, or service any battery pack. (2) Do not crush or cut or puncture the internal battery cell. (3) Do not short-circuit the battery, or expose it to water or other liquids. (4) Do not touch the internal battery cell for any reason. (5) Keep the battery away from fire or a hot oven. Do not dispose of the battery into fire or a hot oven. (6) Keep the product with battery away from extremely low air pressure or high temperature surrounding environment. Battery subjected to extremely low air pressure may result in an explosion or the leakage of flammable liquid or gas. (7) Stop using the battery pack if it is damaged, or if you notice any discharge or the buildup of foreign materials on the battery contacts. (8) Do not put the battery in trash that is disposed of in landfills. When disposing of the battery pack, comply with local ordinances or regulations.
14. CAUTION: Risk of explosion if battery is replaced by any battery other than Lightspeed Part # L3.7V



System Components and Unpacking

The standard configuration of the 975 system includes:

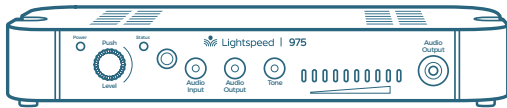

975

Instructional Audio System
and Power Supply

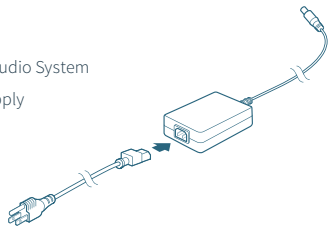

Flexmike

Teacher Microphone



Microphone Cradle Charger

and Power Supply



TIP: The 975 and wireless microphones are paired together at the factory. Please keep all components together as a system. Moving them from one system or room to another will result in the need to re-pair them to function.



Optional Components

Optional equipment which may be part of your 975 system



ShareMike

Student Microphone *(Optional)*



Media Connector

and Power Adapter

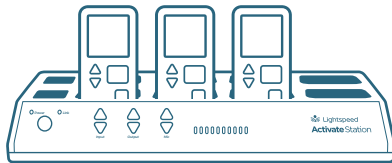

Activate System

Group Learning Pods

For further information on Activate,
please visit www.lightspeed-tek.com



Optional Speakers

Systems can be configured with a variety of ceiling or wall-mounted speakers, including these Lightspeed models.

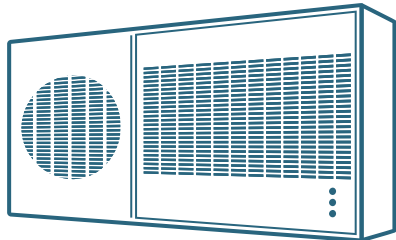

TCQ (x 1)
Hybrid Ceiling Speaker

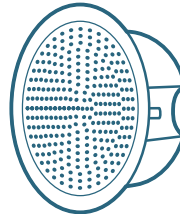

DRQ (x 4)
Ceiling Speaker

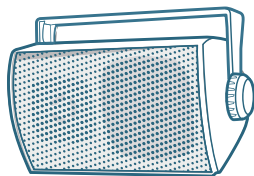

WMQ (x 4)
Wall Speaker
Available in U.S. and Canada only

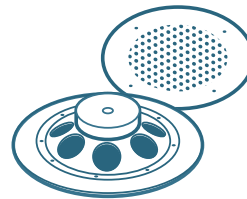

4JCS (4 per room)
Plenum Ceiling Speaker
Available in U.S. only

975 Controls and Indicators

FRONT PANEL

1. **POWER LIGHT**
White light: Power on
2. **POWER BUTTON / VOLUME ADJUSTMENT:** Press this button to turn the system power on or off. This also functions as an adjustment knob for the volume and tone depending on the mode selected (see 5,6,7 below).
3. **STATUS LIGHT:** Microphone link and pair indicators.
Blue light: Microphone(s) is paired to the system
Off: Microphones are not paired to the system
4. **IR RECEIVER:** For pairing to microphone.
5. **AUDIO INPUT VOLUME SELECTOR:** Selects Volume as the mode for the adjustment knob (2) for the audio sources connected to the audio inputs on the back of the 975.
6. **AUDIO OUTPUT VOLUME SELECTOR:** Selects Volume as the mode for the adjustment knob (2) for the audio device connected to the audio output jack on the front of the 975.
7. **TONE SELECTOR:** Selects Tone as the mode for the adjustment knob (2) for the microphone. This adjusts the bass or treble that is heard through the classroom speaker.
8. **AUDIO OUTPUT JACK:** 3.5mm stereo connector for connecting to an assisted listening device (ALD) or to a computer for recording.

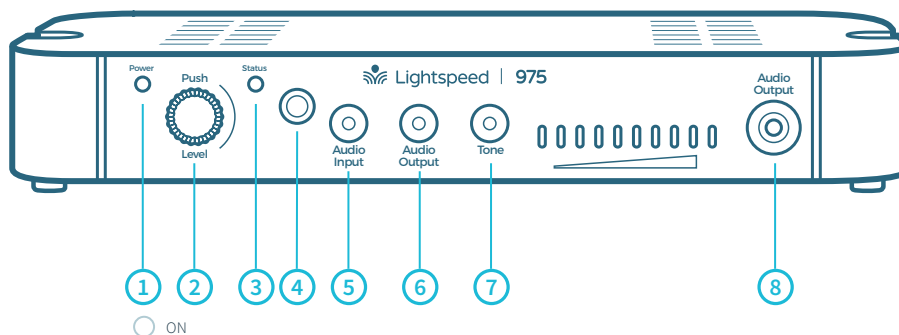

975 Controls and Connections

BACK PANEL

1. **AUDIO INPUTS:** 3.5mm stereo connectors for connecting classroom audio sources to be played through audio system. One optical digital input and one input priority. Input priority mutes other audio to allow only input priority.
2. **INPUT PRIORITY JACK:** Additional 3.5 mm stereo connector that automatically mutes other audio inputs when a signal is detected.
3. **PAGEFIRST ADJUST:** Use the Adjust control to adjust the sensitivity of PageFirst if needed.
4. **PAGEFIRST INPUT:** Connect the input from the optional PageFirst sensor here when interfacing with a building's paging system.
5. **RELAY INPUT:** Senses external relay closure to mute 975 audio when a signal from a fire alarm, IP paging system or other device is detected.
6. **CONTACT CLOSURE:** Internal relay contact closure to provide signal to notify external system based on user input.
7. **SPEAKER OUTPUTS:** This Euroblock connector is used to connect the 975 to the loudspeaker(s). Up to two 8-ohm speakers can be connected to each output.
Note: Wiring to these terminals should follow the Class 2 wiring methods as outlined in the National Electric Code.
8. **DC POWER:** Plug the power supply (24V/2.5A) into this jack.

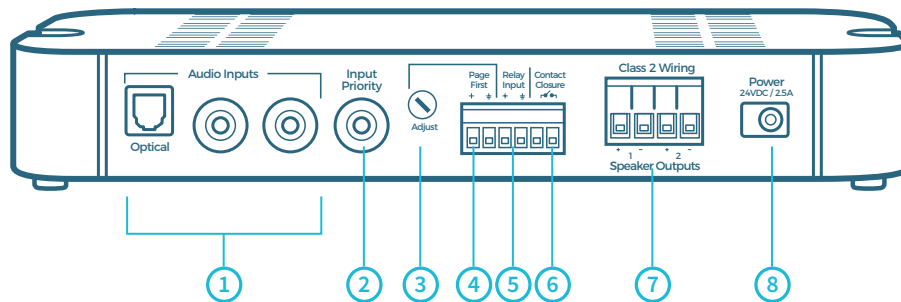



Flexmike Controls and Connections

1. **POWER/MUTE SWITCH:** Press and hold to power on, press to mute or talk, press and hold to power off.
Blue light: Talk
White light: Mute
2. **IR TRANSMITTER:** For pairing to base unit.
3. **MIC 1 STATUS:** lighted to indicate microphone is registered as Mic 1
White: solid = Normal operation
White: flashing = Linking in progress
4. **MIC 2 STATUS:** When using a second microphone, this LED is lighted to indicate microphone is registered as Mic 2
White: solid = Normal operation
White: flashing = Linking in progress
5. **MICROPHONE VOLUME UP/DOWN**
6. **POWER STATUS LIGHT**
Red light: In operation, turns red to indicate low battery.
White light: Normal operation

When charging in Cradle Charger:
Red light: Charging
Green light: Charging complete
7. **EARBUD/MIC CONNECTION:** Connect the earbud for monitoring for use with Pods only, also for use with optional EMA (earset) and LMA (lapel) microphones.
8. **LANYARD INTERFACE:** Insert the lanyard into this hook to wear the Flexmike.
9. **BATTERY:** Remove the battery to replace the rechargeable battery pack.
10. **USB INPUT:** Connect audio source to send to 975. USB input can also be used for charging.

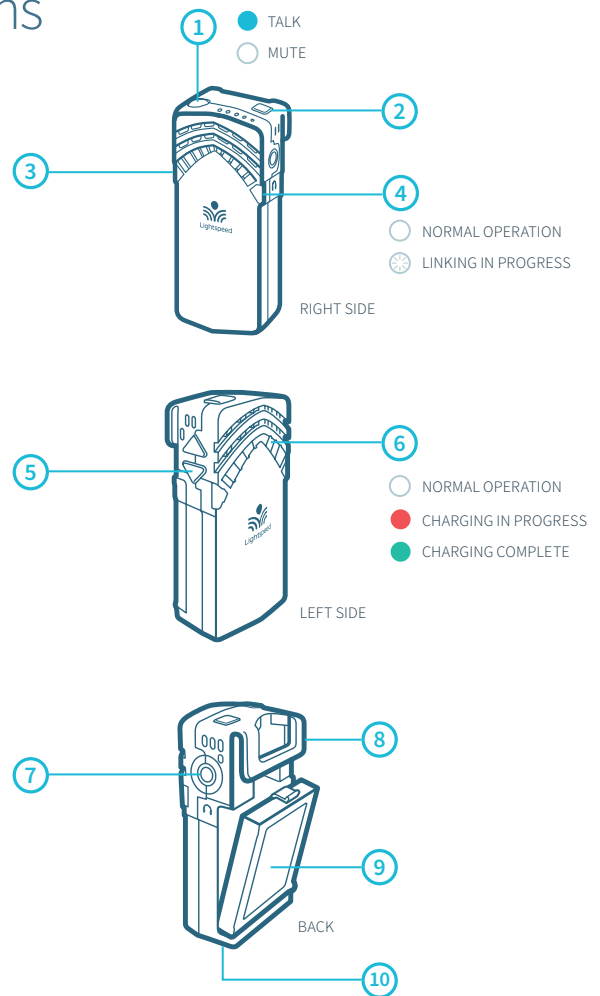

Microphone Cradle Charger

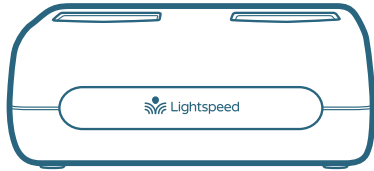

DC POWER PORT: Connect the 5V/1.0A DC power cord

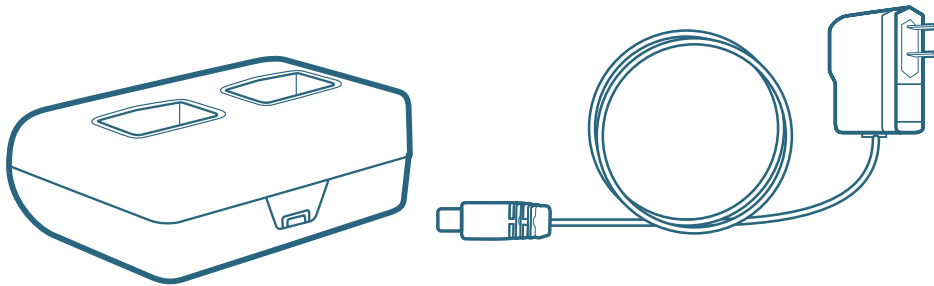

SET-UP & OPERATION

Connecting the Power Supply

- Locate the power supply and AC power cord. Connect the AC power cord into the DC power supply.
- Insert the DC connector into the “Power” on 975 and plug the other end to an electrical outlet.
- The 975 automatically powers on and the white Power light on the front panel will appear.



975

Classroom Audio System
and Power Supply

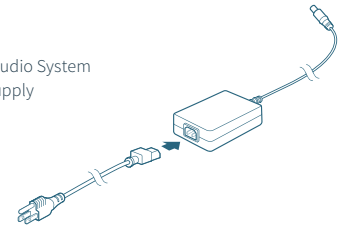

Once the Flexmike is charged, follow these steps for use.

- Once initial volume level is set, walk around the room and listen for overall audio quality.
- If further fine tuning is required, you may need to adjust the Tone Control on the front of the 975.





Charging the Flexmike

BEFORE USE, THE FLEXMIKE SHOULD BE CHARGED

It will take 5-6 hours for the Flexmike to obtain a full charge. A fully charged Flexmike will last for up to 8 hours of use. If microphones are used daily, they should be charged each night.

Replacement lithium polymer battery packs may only be purchased through Lightspeed (part # L3.7V).

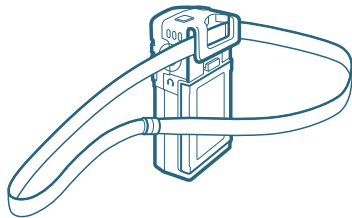

ATTACH LANYARD

Hang the Flexmike on the lanyard opposite the magnetic clasp.

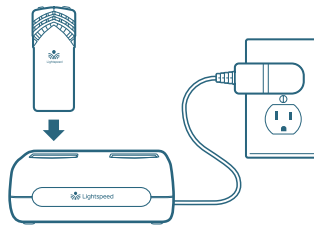

CONNECT CRADLE CHARGER

Plug power cord into the cradle charger and then plug the AC end into an electrical outlet.

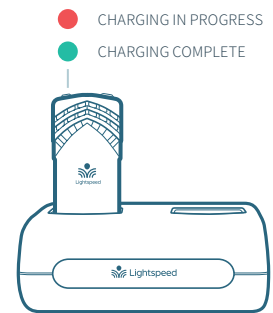

CHARGE FLEXMIKE

Place the microphones into the cradle charger. The power status light will glow red when it is charging. When charging is complete, the power status light will glow green.

It takes about 5-6 hours to fully charge the microphone battery.

Daily Use of the Flexmike

1. AT THE START OF THE DAY, REMOVE FLEXMIKE FROM THE CHARGER

- The microphone will default to the Mute position, the status light will turn to white.
- Place the microphone around your neck.
- Press the power/mute button. The light will turn blue, indicating the microphone is active and ready to use.
- Adjust volume with the UP/DOWN buttons if necessary.
- If Flexmike needs to be powered down for some time, press and hold the power button. To power Flexmike again, press and hold the power button until the power status light turns white.

2. PRIVATE CONVERSATIONS

- Mute the Flexmike during private conversations by momentarily pressing the power button. When muted, the blue light turns white.
- When conversation is over, momentarily press the power button again to unmute the Flexmike.

3. END OF DAY

- Place the Flexmike into the cradle charger and make sure the Power Supply is plugged in to an electrical outlet.
- The Flexmike will stay powered on during charging, but will automatically be muted.
- It is not necessary to turn off the 975 at end of day, but you may do so by pressing the power button on the front panel.
- If you do want to power it down, when Flexmike is removed from charging the next day, it will automatically power the 975 on.

POWER / MUTE BUTTON
& STATUS LIGHT



VOLUME
CONTROL

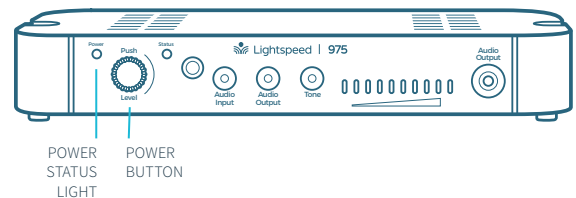

POWER
STATUS
LIGHT

POWER
BUTTON

Pairing your Microphone



Your system is shipped with microphones and base units pre-paired for quick and easy use.
If, for any reason, you need to pair new components, follow this pairing process:

①

From a powered off state, point the IR transmitter lens toward the 975 (for ShareMike, the transmitter lens is located on the back of the microphone).

②

Press and hold the power button for 5 seconds until the mic 1 and mic 2 lights start flashing, then release the button and let the pairing process finish.

③

The "status" light on the base unit will light up indicating the pairing process is complete. The mic 1 or mic 2 light on the microphone will stay illuminated.

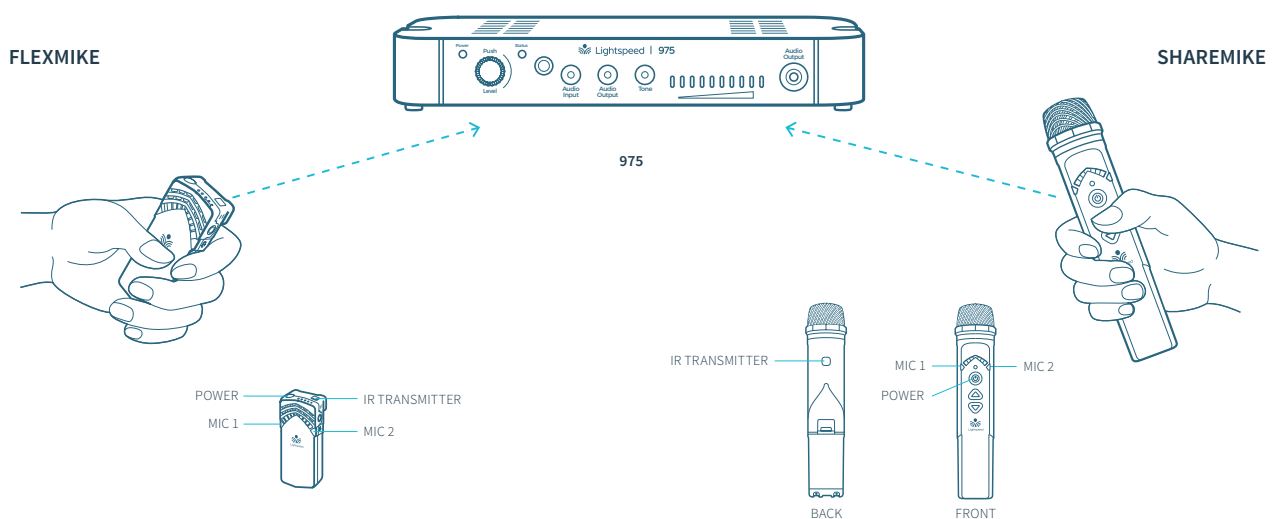

Using the Life Safety Functions

The 975 connects and responds to several important third-party life safety solutions.



1. Input Priority

MUTES CLASSROOM AUDIO SYSTEM

When an audio source is connected to the Input Priority jack, an audio signal from that source will automatically mute all other audio inputs to allow it to be heard without interference. The 975 is shipped with a removable plug inserted into the Input Priority jack to ensure that the connection to an audio source is intentional.



2. PageFirst

MUTES CLASSROOM AUDIO SYSTEM

When the PageFirst sensor clip is connected to an external paging source, all audio signal is muted to ensure paging is heard clearly.

See page 17 for installation details



3. Relay Input

MUTES CLASSROOM AUDIO SYSTEM

When the 975 is connected to a fire alarm, audio signals going through the unit are muted when the fire alarm is activated to minimize distractions from the sound of the alarm.



4. Alert Notification

INITIATES ALERT WITH FLEXMIKE

If your building is equipped with an alert notification system, simultaneously holding down the volume up and down buttons for three seconds on the Flexmike activates the contact closure function on the 975. External systems sense this contact closure to perform a prescribed action, notifying the appropriate parties of a classroom alert.

See page 17 for details

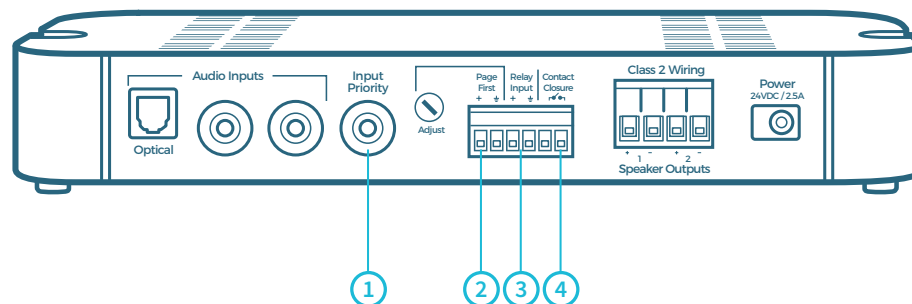

Installing PageFirst Sensor *(optional)*

This 975 can interface with an independent classroom paging system.

When a page is broadcast, all audio from the system is muted, ensuring important school-wide messages are not missed. Please note that PageFirst is not compatible with telephone or IP-based paging systems.

How it works:

1. PageFirst sensor clip is hung around a lead wire attached to the classroom paging speaker.
2. The clip is hard-wired to the amplifier.
3. As a page is broadcast, the sensor clip detects the audio signal through induction and immediately mutes the amplifier.
4. When the page is over, the audio from the amplifier returns to normal volume level.

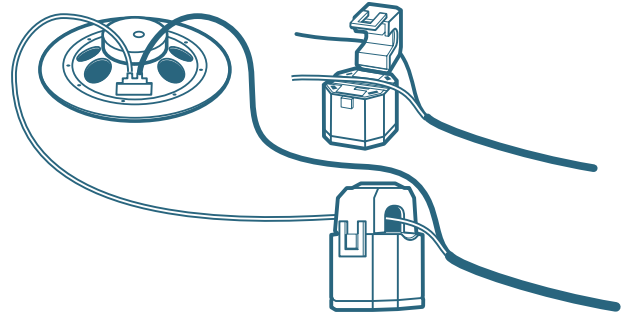

USING ALERT NOTIFICATION

If your building is equipped with an alert notification system, you can use the Flexmike to send an alert. This activates the contact closure function on the 975, which external systems use to perform a prescribed action, such as notifying the appropriate parties of a classroom alert.

How it works:

1. To send an alert, simultaneously hold down the volume up and volume down buttons on the Flexmike for three seconds.

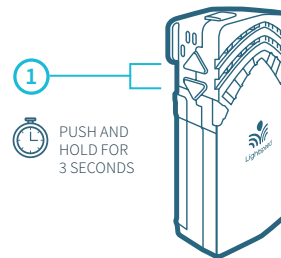

Output Audio to Assistive Listening Device (ALD)

1. Press the Audio Output Selector first, then turn the volume control on the front panel all the way down (fully counterclockwise).
2. Determine the type of audio input jack on the ALD as manufacturers' products differ in connector size and shape. Many require a 3.5 mm to 3.5 mm patch cable (part# MSC3535, not included).
3. Connect a patch cable from the ALD microphone jack or AUX input to AUDIO OUT jack on the front of the 975.
4. With the 975 and ALD turned on, speak into the Flexmike and slowly adjust the corresponding volume control on the 975 until the appropriate audio level is obtained in the ALD.
5. It may be necessary to adjust the volume on the ALD to achieve appropriate volume level.

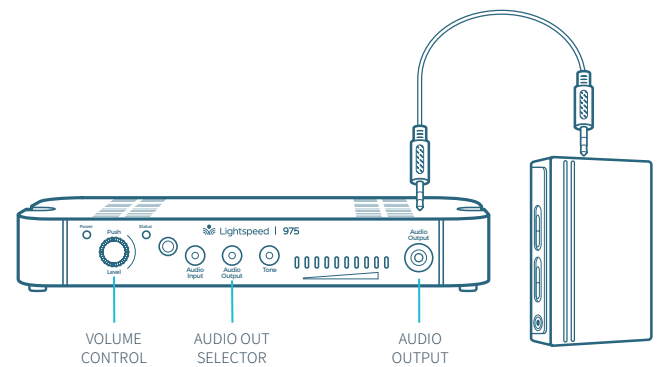

Using Your Microphone as a Wireless Audio Link

You can connect your 2nd (or 3rd) microphone to your computer's USB port to enable a wireless 2-way audio link.

SEND AUDIO FROM THE COMPUTER to the 975 to ensure all audio from the computer (videos, video conferencing, audio books, music, etc) can be played through the Lightspeed 975 system and speakers.

SEND AUDIO TO THE COMPUTER from the 975 to ensure the teacher's Flexmike and any student microphones are clearly picked up by a video conferencing solution.

1. With the appropriate USB cable (USB-C for Flexmike/Sharemike) connect your microphone to your computer's USB port. This will also power/charge your microphone.
2. Open sound settings on your computer:
 - Select Lightspeed Audio as the Output source to send all computer audio to the 975 system
 - Select Lightspeed Audio as the Input source to use the Lightspeed microphones as the computer microphone audio for video conferencing and recording applications.
3. You may also need to select Lightspeed Audio as the speaker and microphone audio in your video conferencing application the first time you use it.

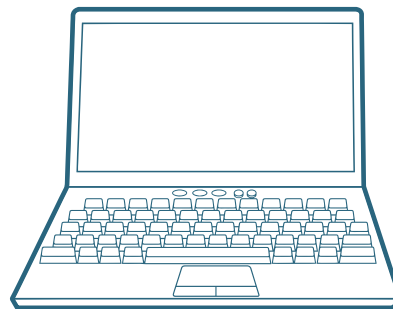

Plug your external audio equipment, such as a computer, into the USB input on the bottom of the Flexmike

2-WAY USB

2-WAY USB
AUDIO OUTPUT

USB cable sold separately. Lightspeed offers a USB-A to USB-C cable for sale (part #USBC)



TIP: If your system includes two Flexmikes, you can use one mic for instruction and the second mic to transmit audio through the system.



Audio Integration

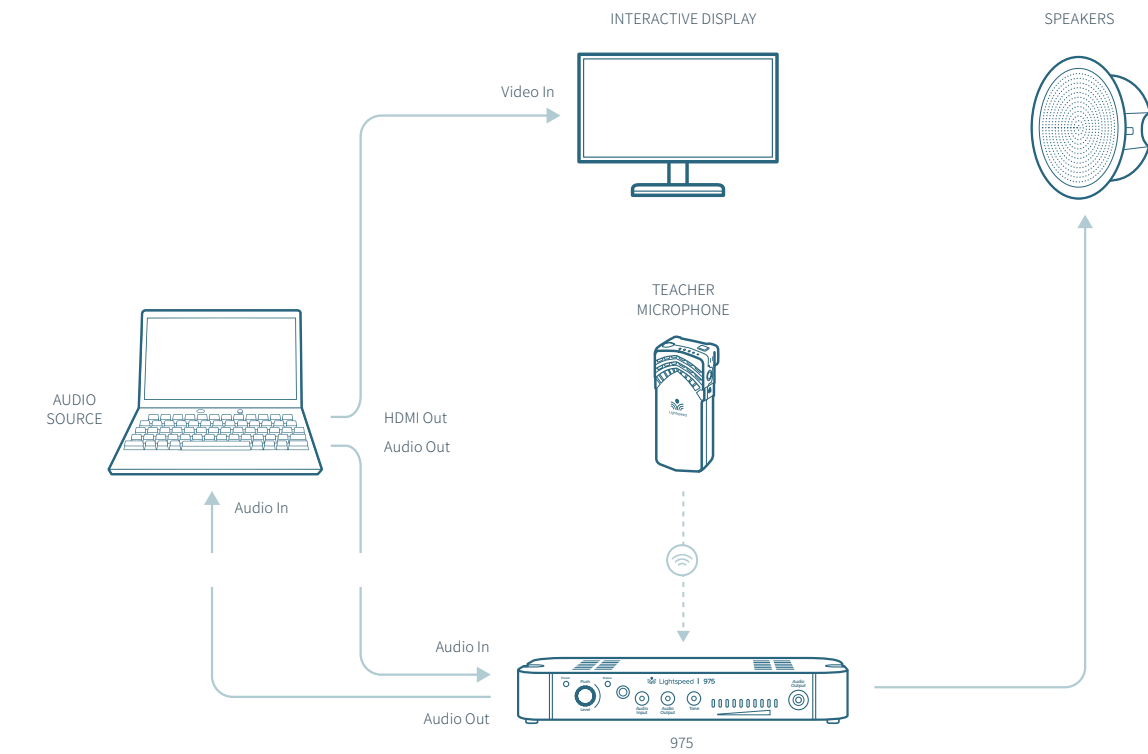

 Lightspeed Access transmission protocol

OPTIONAL COMPONENTS

Sharemike Controls and Connections

1. **POWER BUTTON**
2. **POWER STATUS LIGHT**
Red light: During operation, turns red to indicate low battery
White light: Normal operation

When charging in Cradle Charger:
Red light: Charging
Green light: Charging complete
3. **MIC 1 STATUS:** Lighted to indicate microphone is registered as Mic 1
White: solid = Normal operation
White: flashing = Linking in process
4. **MIC 2 STATUS:** Lighted to indicate microphone is registered as Mic 2
White: solid = Normal operation
White: flashing = Linking in process
5. **MUTE/TALK STATUS LIGHT**
Blue: solid = Talk
White: solid = Mute
6. **MICROPHONE VOLUME UP/DOWN**
7. **USB INPUT:** Connect audio source to send to 975. USB input can also be used for charging.
8. **IR TRANSMITTER:** For pairing to base unit
9. **AUDIO INPUT:** Plug a laptop or other audio device into this jack to wirelessly transmit the audio signal to be played through the system.
10. **VOLUME LOCK:** Disables volume controls.

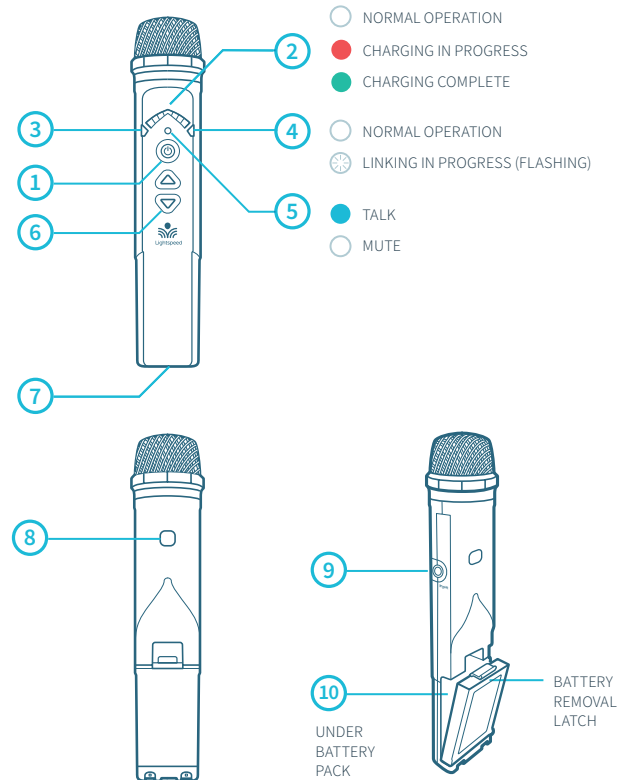



Sharemike: Charging

1. Make sure the charger is plugged into a wall outlet.
2. The power status light on the microphone will glow red to indicate charging.
3. Leave the Sharemike in the charger overnight to obtain a full charge. It takes about 5-6 hours to fully charge the battery. The light will turn green when charging is complete.

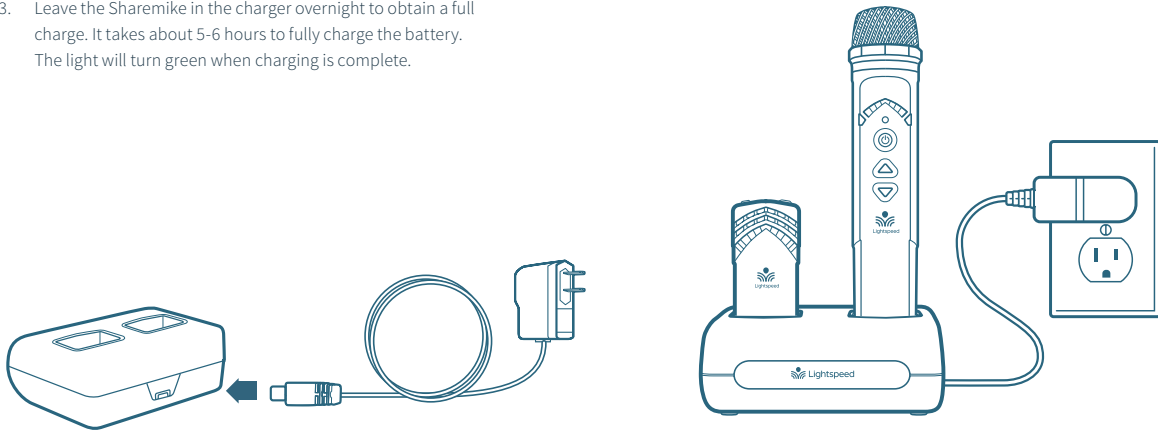

PLEASE NOTE: The 975 and microphone(s) are paired together at the factory and all components should be kept together as a system. Moving them from one system, or room, to another will result in the need to re-pair.



Sharemike: Initial Set-Up

1. Ensure the 975 is on. The white power light will glow.
2. Turn on the Sharemike by pressing and holding the power button until the LED lights.
3. Grip the barrel in the center section.
4. While speaking in a normal voice, increase the volume with the Sharemike until your voice is barely audible.

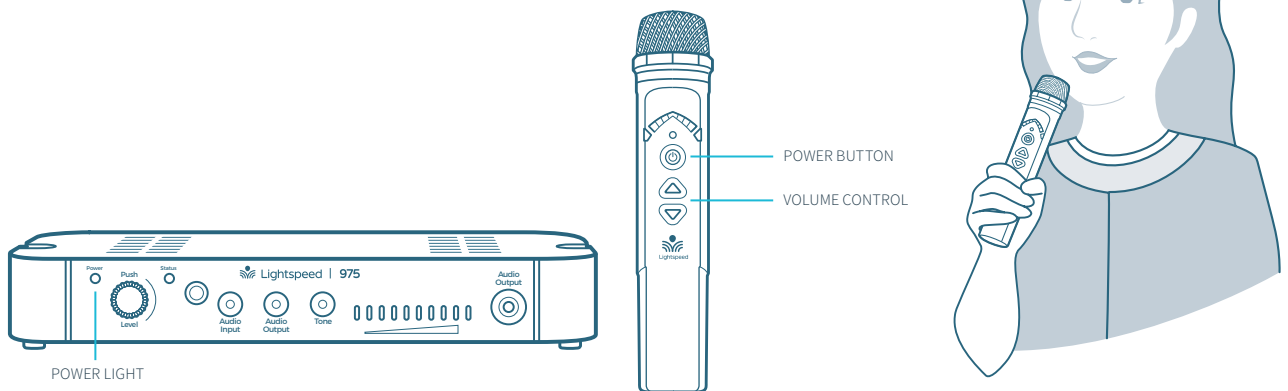

PLEASE NOTE: This equipment is designed to supplement and distribute the user's voice so they are able to speak in a conversational tone. Having the volume set too high will result in feedback and listener fatigue.

Media Connector Controls and Indicators

FRONT PANEL

1. **POWER LIGHT**
White light: Power on
2. **POWER BUTTON / VOLUME ADJUSTMENT:** Press this button to turn the system power on or off. This also functions as an adjustment knob for the volume and tone depending on the mode selected (see 4, 5, 6 below).
3. **STATUS LIGHT:** Microphone link and pair indicators.
Solid blue: Microphone(s) is paired to the system
Off: Microphones are not paired to the system
4. **AUDIO INPUT VOLUME SELECTOR:** Selects Volume as the mode for the adjustment knob (2) for the audio sources connected to the audio inputs on the back of the Media Connector.
5. **AUDIO OUTPUT VOLUME SELECTOR:** Selects Volume as the mode for the adjustment knob (2) for the audio device connected to the audio output jack on the back of the Media Connector.
6. **TONE SELECTOR:** Selects Tone as the mode for the adjustment knob (2) for the microphone. This adjusts the bass or treble that is heard through the classroom speaker.

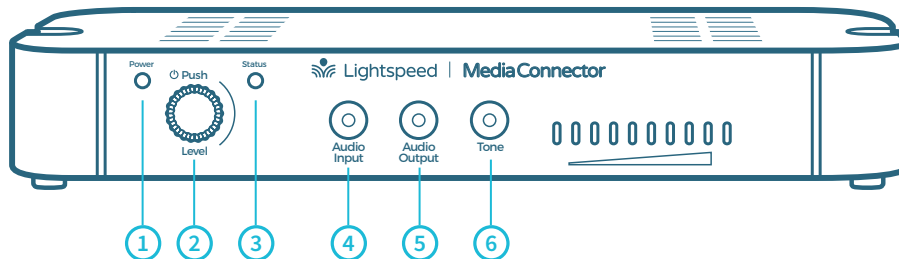

Media Connector Controls and Indicators (Optional)

BACK PANEL

1. **AUDIO INPUTS:** 3.5mm stereo connectors for connecting classroom audio sources to be played through audio system.
2. **AUDIO OUTPUTS:** 3.5mm stereo connectors for connecting to an assisted listening device (ALD) or to a computer for recording.
3. **USB INPUT:** Plug the USB-C end of the power cable into this USB port on the Media Connector.
 - The USB port supplies power to Media Connector when connected to the Media Connector power supply, or from a laptop.
 - It also acts as an input for a digital audio when connected to an audio source. Note that when the USB is used for audio input, the other four audio input jacks are not operational.

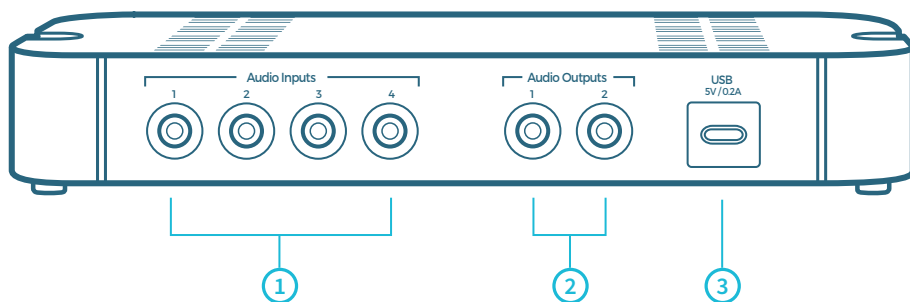



Media Connector Set Up and Operation

DETERMINE LOCATION

Media Connector is designed to be connected to the primary media source in the classroom, usually the computer or display panel.

WALL MOUNT OR DESKTOP

The Media Connector can be placed on a table surface or wall-mounted.

- Choose a location that is convenient to the classroom audio sources and power supply.
- It should be located 3-6 feet off of the floor to allow for good transmission.
- Do not enclose in a metal cabinet or in a location where the signal will be obstructed.

NOTE: The Media Connector does not require a direct line of sight to the 975. However it functions best when no obstructions are between the two devices.



CONNECT TO POWER

Connect the USB power cord to a computer. Plug the USB cable into the USB input on the back of the Media Connector.

or

Use the USB power adapter to plug into a wall outlet.

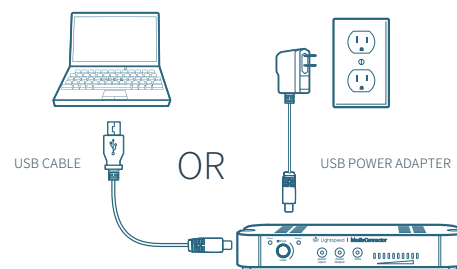

Connecting Media Connector to Audio

Audio can be connected using either a digital 2-way USB audio or analog audio.

USB AUDIO

If locating and connecting to computer USB, Media Connector will default to digital USB audio (3.5mm analog audio ports will be disabled). USB audio enables a 2-way audio link to:

Send audio from the computer to the 975 to ensure all audio can be played through the 975 system.

Send audio to the computer from the 975 to ensure the teacher's Flexmike and any student microphones are clearly picked up by a video conferencing solution.

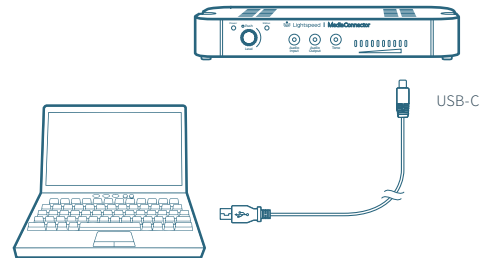

ANALOG AUDIO

Plug your external audio equipment (e.g., video display) into one of the Audio input jacks.

Adjust the volume as needed by pressing the Audio Input selector and adjusting the level knob as needed.

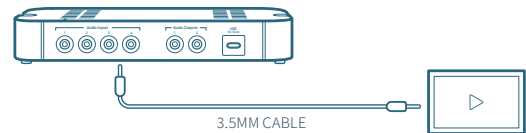

COMPUTER SETTINGS

Once connected, open computer sound setting to select "Lightspeed Audio" as the microphone and speaker.

SETTING THE VOLUME LEVELS

For recording, or to interface with an Assistive Listening Device, connect a 3.5mm cable to the Audio Output of the Media Connector to the microphone input on the device. Press the button for the desired level adjustment.

- Turn the knob to adjust volumes up or down for Audio Input/Output
- To adjust the Tone (bass/treble) of the speaker, press Tone and use the adjustment knob to turn the bass up and down



Pairing 975 to Media Connector



Your system is shipped with microphones and base units pre-paired for quick and easy use. If, for any reason, you need to pair new components, follow this pairing process:

①

From a powered on state, point the IR transmitter lens toward the 975 (for ShareMike, the transmitter lens is located on the back of the microphone).

②

Press and hold the Flexmike power button for 5 seconds until the mic 1 and mic 2 lights start flashing, then release the button. At this point, the status light on Topcat will blink for 30 seconds. If after 30 seconds the status light blinks rapidly, you will need to start the pairing process again.

③

Press and hold the Tone selector button for 5 seconds to put it into pairing mode.

When the status lights are solid on both the 975 and Media Connector, pairing is successful.

975



STATUS LIGHT



FLEXMIKE



MEDIA CONNECTOR

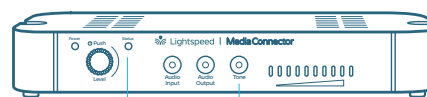

STATUS LIGHT

TONE SELECTOR
BUTTON

Activate System with Pods

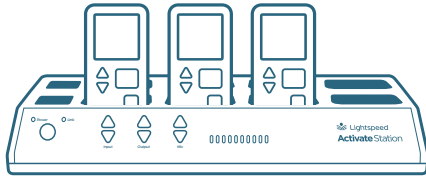

FOR SMALL GROUP INSTRUCTION

Activate with Pods is a two-way communication system that can be seamlessly added to the 975 system to facilitate small group instruction.

With the small group audio pods and the Activate app, Activate opens up communication and interaction between the teacher and student groups, including:

- Teacher monitoring of individual small groups
- Direct instruction to each independent group
- Student group sharing with the whole class
- Reinforce and redirect group activities
- Capture audio and video of student groups or of individual speaker

If your 975 system was configured with Activate pods, please refer to the Activate System user guide for operation and setup instructions.

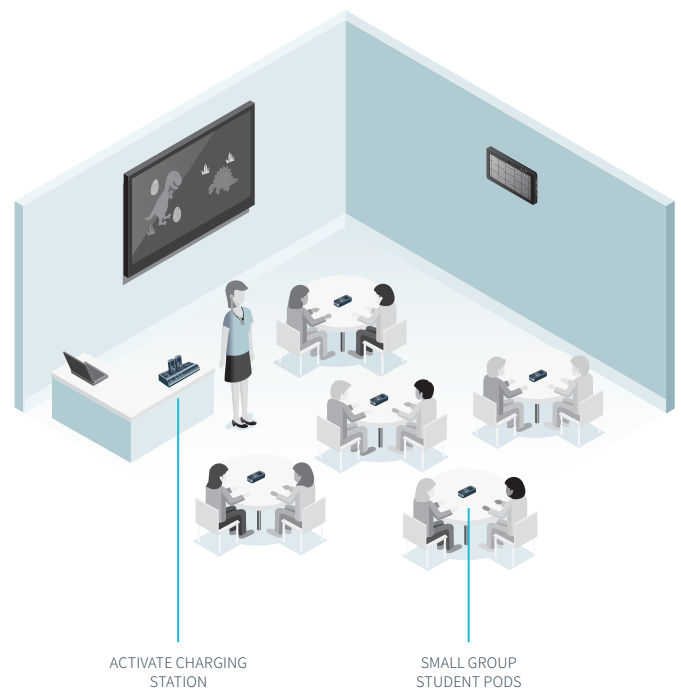

MAINTENANCE & TROUBLESHOOTING

Flexmike Battery Replacement

Battery part #L3.7V

1. Push down on the latch and carefully pull the battery pack away from the Flexmike.
2. Insert new battery pack as shown and make sure the latch is secure.
3. Place the Flexmike in a cradle charger to charge the battery pack.

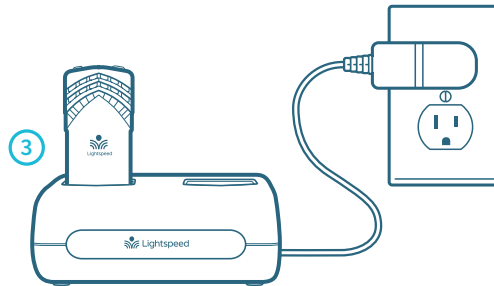
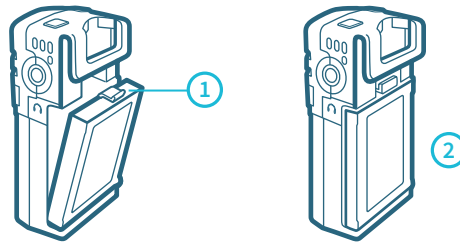



ShareMike Battery Replacement

Battery part #L3.7V

1. Push down on the latch and carefully pull the battery pack away from the ShareMike.
2. Insert new battery pack as shown and make sure the latch is secure.
3. Place the Flexmike in a cradle charger to charge the battery pack.

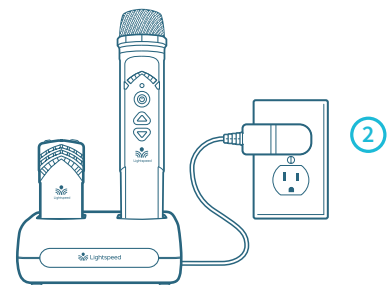
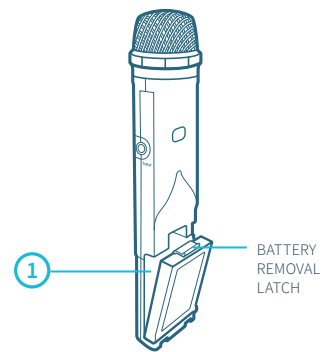

Troubleshooting

PROBLEM: Low battery indication: Most problems are directly related to low battery power. Please run through the "Battery Check" items first. For remaining troubleshooting, use known good, fully-charged batteries.

SOLUTION: Battery Check

- Confirm batteries are charged each night. A solid red light on the battery status light indicates a low battery.
- Confirm proper batteries are used: Flexmike and Sharemike require the Lightspeed #L3.7V rechargeable battery pack.
- Make sure the microphones obtain a full charge. A full charge takes 5-6 hours.
- When charging the transmitter, the red charging light is solid. The green light will be solid when a full charge is reached.

PROBLEM: Microphone doesn't indicate a "Ready" signal (solid white light)

SOLUTION: Follow these steps to ensure the system is ready to use.

- Ensure the power button on the microphone is turned on. Once turned on, the white light should begin blinking.
- Power the microphone off, then on again after a few seconds. Wait for up to 30 seconds for the white light to turn solid, indicating READY for operation.

PROBLEM: Low volume or feedback

SOLUTION: Follow these steps to eliminate low volume or feedback:

- If the volume is too high, feedback will occur. Adjust accordingly.
- Adjust the volume level on the Flexmike.

PROBLEM: No sound from speaker and wireless components

SOLUTION: Follow these steps to produce sound from 975:

- Confirm that the white POWER light located on the front panel of the 975 is on.
- Confirm the microphone is powered on and linked to the 975. The Mic 1 status light will be white on the 975 indicating the microphone is linked.
- Confirm that the microphone is turned on. There will be a solid blue light on the top of microphone to indicate it is powered on and ready.
- Confirm that microphone is not muted. A solid white light on the top of microphone will indicate it is muted.
- Check speaker connections on the 975. Make sure the cables are properly connected (see page 8 of this manual or the Installation Guide for more information).
- If an Activate Station or Media Connector is paired with the 975, make sure that the volume level of the Activate or the Media Connector is not turned down all the way.
- Slowly turn up the volume level while talking into the microphone.

If you still have questions after reviewing these instructions, call Lightspeed Technical Services at 800.732.8999, 5am-5pm, PST.

Customers outside the U.S. should contact their local reseller.

Tips for Optimum Audio Performance

- **Speak in a natural voice.** A normal conversational speech level will provide an adequate signal. It is not necessary to increase the intensity of your voice—the audio system provides adequate amplification (approximately 5–10 dB) above ambient room noises.
- Avoid **wearing jewelry** that may rub or bump against the microphone.
- **Mute the Flexmike** during private conversations with a student, parent, or other classroom visitor. You can tell the mic is muted when the light turns white.
- **Recharge microphones each night.** When recharged nightly, operating time (actual usage) for the microphones will last through a typical school day.

WARRANTY, SAFETY & SPECIFICATIONS

Five-Year Limited Warranty

Lightspeed Classroom Audio Systems are guaranteed against malfunction due to defects in materials and workmanship for a period of five (5) years, beginning at the date of the purchase invoice. If such malfunction occurs, the product will be repaired or replaced (at Lightspeed's option) without charge during the warranty period.

Lightspeed's Warranty Exchange Program applies to all classroom audio systems within the five (5) year warranty period. If a classroom audio product or component has an issue that requires service, a refurbished replacement will immediately be sent to the customer to minimize downtime. Customers will receive the exchange product(s) or component(s) within 2-3 days. A prepaid return label will be included with exchanged products so original malfunctioned equipment can be returned to Lightspeed. Any exchanged equipment will remain covered under the original five-year warranty.

1. Warranty on transceivers is five (5) years.
2. Warranty on Lightspeed NiMH and Lithium Polymer rechargeable batteries is one (1) year.
3. A prepaid shipping label will be provided by Lightspeed for warranty repairs within the United States. Customers outside the U.S. should refer to the Lightspeed website (www.lightspeed-tek.com) for warranty repair instructions.
4. Warranty does not extend to finish, appearance items, or malfunctions due to abuse or operation other than specified conditions, nor does it extend to incidental or consequential damages. Repair by other than Lightspeed or its authorized service agencies will void this warranty. Information on authorized service agencies is available from Lightspeed Technologies, Inc.

Our Service Department (800.732.8999, 5am-5pm, PST) will handle your repair or replacement needs.

Customers outside the U.S. should contact their local reseller.

Safety Warnings and Certifications



CAUTION

RISK OF ELECTRICAL SHOCK

DO NOT OPEN



THIS PRODUCT MUST BE INSTALLED IN ACCORDANCE WITH THE APPLICABLE INSTALLATION CODE BY A PERSON FAMILIAR WITH THE CONSTRUCTION AND OPERATION OF THE PRODUCT AND THE HAZARDS INVOLVED.



The **lightning flash** with arrowhead symbol inside an equilateral triangle is intended to alert the user to the presence of non insulated "hazardous voltage" within the product's enclosure, which may be of sufficient magnitude to induce a risk of electric shock to persons.



The **exclamation mark** inside an equilateral triangle is intended to alert the user to the presence of important operating and maintenance (servicing) instruction in the literature accompanying this product.



USE A LIGHTSPEED SUPPLIED BATTERY ONLY



CAUTION: Risk of explosion if battery is replaced by an incorrect type. Dispose of used batteries according to the instructions.



Battery subjected to extremely low air pressure that may result in an explosion or the leakage of flammable liquid or gas.

CERTIFICATIONS



This product is listed to UL standards and requirements for electrical safety by Underwriters Laboratories Inc.



This product conforms with the essential requirements of the following European Union Directives: 2004/108/EC Electromagnetic Compatibility (EMC) and 2006/95/EC Low Voltage Directive (LVD).



Lightspeed Technologies launched a formal product recycle program in Europe that complies with the European Union Directive 2002/96/EC on Waste Electrical and Electronic Equipment ("WEEE Directive"). Please visit www.lightspeed-tek.com for more information.



This product is manufactured using lead-free processes and is free of other materials harmful to the environment. It conforms to the most stringent new European guidelines for consumer products (RoHS).

Précautions De Sécurité et Certifications



ATTENTION
RISQUE D'ÉLECTROCUTION
NE PAS OUVRIR



CONFORMÉMENT AUX NORMES D'INSTALLATION APPLICABLES, CE PRODUIT DOIT ÊTRE INSTALLÉ PAR UNE PERSONNE FAMILIARISÉE AVEC LA CONCEPTION ET LE FONCTIONNEMENT DU PRODUIT ET CONSCIENTE DES RISQUE ENCOURUS.



L'éclair flèche dans un triangle équilatéral avertit l'utilisateur de la présence d'une "tension dangereuse" non isolée à l'intérieur de l'appareil, qui peut être d'une ampleur suffisante pour constituer un risque d'électrocution.



Le point d'exclamation contenu dans un triangle équilatéral avertit l'utilisateur de la présence d'importantes instructions d'exploitation et de maintenance dans la documentation qui accompagne ce produit.



UTILISEZ UNIQUEMENT LA BATTERIE
LIGHTSPEED FOURNIE



ATTENTION: Risque d'explosion si la batterie est remplacée par un type incorrect. Mettre au rebut les batteries usagées selon les instructions.

CERTIFICATIONS



Ce produit est certifié conforme aux normes et aux exigences UL en matière de sécurité électrique par Underwriters Laboratories Inc.



Ce produit est conforme aux principales exigences des directives de l'Union Européenne suivantes : 2004/108/EC Electromagnetic Compatibility (EMC) and 2006/95/EC Low Voltage Directive (LVD).



Lightspeed Technologies a lancé un programme de recyclage de produits en Europe conformément à la directive de l'Union Européenne 2002/96/CE relative aux déchets d'équipements électriques et électroniques (directive « DEEE »). Veuillez visiter notre page Web www.Lightspeed-tek.com pour plus de renseignements.



Ce produit est fabriqué en utilisant des processus sans plomb ni aucune autre matière nuisible à l'environnement. Il est conforme aux nouvelles règles européennes les plus strictes en matière de biens de consommation (RoHS).

Canada, Industry Canada (IC) Notices

English

This device complies with Industry Canada license exempt RSS standard(s). This Class B digital apparatus complies with Canadian ICES-003 and CAN ICES-3(B)/NMB-3(B). Operation is subject to the following two conditions: (1) this device may not cause interference, and (2) this device must accept any interference, including interference that may cause undesired operation of the device. The IC for this device is IC ID 1732B-LS975. This includes accessories such as the Flexmike (IC 1732B-LSFMN), Sharemike (IC 1732B-LSSMN) and Media Connector (IC 1732B-LSMCN).

French

Canada, avis d'Industrie Canada (IC)

Cet appareil numérique de classe B est conforme aux normes canadiennes ICES-003 et RSS-247. Son fonctionnement est soumis aux deux conditions suivantes: (1) cet appareil ne doit pas causer d'interférence et (2) cet appareil doit accepter toute interférence, notamment les interférences qui peuvent affecter son fonctionnement. L'identifiant IC de cet appareil est IC ID 1732B-LS975. Ceci inclut les accessoires comme le Flexmike (IC 1732B-LSFMN), Sharemike (IC 1732B-LSSMN) et un Media Connector (IC 1732B-LSMCN).

Cet équipement est conforme aux limites d'exposition aux radiations IC inaux doivent suivre les instructions d'utilisation spécifiques pour satisfaire la conformité à l'exposition IC, veuillez suivre les instructions de fonctionnement décrites dans ce manuel.

RF Radiation Exposure Statement

English

Your mobile device is a radio transmitter and receiver. It is designed not to exceed the limits for exposure to radio waves (radio frequency electromagnetic fields) recommended by international guidelines. The guidelines were developed by Health Canada and include a substantial safety margin designed to assure the safety of all persons, regardless of age and health.

French

Votre appareil mobile est un émetteur-récepteur radio. Il est conçu pour ne pas dépasser les limites d'exposition aux ondes radio (champs électromagnétiques de fréquence radio) recommandées par les directives internationales. Les lignes directrices ont été élaborées par Santé Canada et comprennent une marge de sécurité importante destinée à assurer la sécurité de toutes les personnes, indépendamment de l'âge et de la santé.

NOTICE FOR USB

NOTE: Lightspeed is not responsible for any changes or modifications not expressly approved by the party responsible for compliance. Such modifications could void the user's authority to operate the equipment.

NOTE: This equipment has been tested and found to comply with the limits for a Class B digital device, pursuant to part 15 of the FCC Rules. These limits are designed to provide reasonable protection against harmful interference in a residential installation. This equipment generates, uses and can radiate radio frequency energy and, if not installed and used in accordance with the instructions, may cause harmful interference to radio communications. However, there is no guarantee that interference will not occur in a particular installation. If this equipment does cause harmful interference to radio or television reception, which can be determined by turning the equipment off and on, the user is encouraged to try to correct the interference by one or more of the following measures:

- Reorient or relocate the receiving antenna.
- Increase the separation between the equipment and receiver.
- Connect the equipment into an outlet on a circuit different from that to which the receiver is connected.
- Consult the dealer or an experienced radio/TV technician for help.

EU Declaration of Conformity

According to EU Directives EMC 2014/30/EU, LVD 2014/35/EU, RED 2014/53/EU

Manufacturer: Lightspeed Technologies, Inc.
Address: 11509 SW Herman Rd.
Tualatin, Oregon 97062

We herewith declare that the following systems comply with the appropriate basic safety and health requirements of the Directive based on its design and type, as brought into circulation by us. In case of alteration of the system, not agreed upon by us, this declaration will lose its validity.

Products: Redcat, Topcat, 975, Access Link, Flexmike, Sharemike, Pod, Activate Station, Media Connector, TCQ2, DRQ, Mobile Connector
Model Numbers: LSRCNG, LSTCNG, LS975G, LSALNG, LSFMNG, LSSMNG, LSPOD 1881, LSACT 1881, LSMCNG, TCQ2, DRQ, MC

As applicable, products conform to the following EU/AS/NZ test standards listed below:

Safety Standards: EN 62368-1
EMC/RF Standards: EN 301406 V2.2.2 (2016-19)
EN 301489-1/-6
EN 301489-1/-17
EN 50371 (2002)
EN 50385 (2017)
EN 300 328
EN 55022
EN 55024
AS/NZ CISPER 22
AS/NZ 4268

The Technical Construction File is available to proper authorities and the product is CE marked.

Lightspeed Representative

Date: April 22, 2021



Michael Frost, Compliance Engineer

System Components

STANDARD COMPONENTS

975	Wireless audio base station
24V-2.5A-NA	24V/2.5A power supply for 975
FSCC	Transceiver cradle charger, power supply
5V1C	5V power supply for FSCC
FMN	Flexmike classroom transceiver with battery pack and lanyard
L3.7V	Lithium Polymer rechargeable battery pack for Flexmike, one per Flexmike
FL	Flexmike lavalier cord
SPEAKERS	As ordered

STANDARD COMPONENTS (outside U.S. and Canada)

975-1881	Wireless audio base station
24V-2.5A	24V/2.5A power supply for 975, specify country
FSCC -INT	Transceiver cradle charger, power supply
5V1C -INT	International 5V power supply for FSCC
FMN -1881	Flexmike classroom transceiver with battery pack and lanyard
L3.7V	Lithium Polymer rechargeable battery pack for Flexmike, one per Flexmike
FL	Flexmike lavalier cord
SPEAKERS	As ordered

OPTIONAL ACCESSORIES

SMN	Sharemike handheld transceiver with battery pack
L3.7V	Lithium Polymer rechargeable battery pack for Sharemike
USB C	Charging cable for Sharemike
EMA	Earset microphone with TRRS connector for Flexmike
LMA	Lapel microphone with TRRS connector for Flexmike

System Specifications

975

Description	Wireless audio hub
Frequency response	60 Hz - 7 kHz
DC power input	24V/2.5A
Power output	40 Watts total (20 W/channel)
Total harmonic distortion	<1% @ 10W
Wireless communication	Access Technology (1.9 GHz)
Tone control	1 bass/treble control
Audio inputs	Three (3) 3.5mm stereo with volume control, one optical
Audio output	3.5mm stereo with volume control
PageFirst input	Euroblock
Audio Link indicators	1 indicator to show link to microphone
Device registration	IR receiver to start pairing process with Flexmike(s), Sharemike(s), pods, and Media Connector
Dimensions (W x H x D)	7.6" x 5" x 1.13" (193 x 127 x 29mm)
Weight	9.6 oz. (272g)

FLEXMIKE (1-2)

Description	Pendant-style transceiver
Earbud lanyard	Magnetic clasp with integrated earbud
Wireless communication	Access Technology (1.9 GHz)
Audio distortion	<1%
Integrated microphone	Uni-directional electret
Earbud output	3.5mm
Audio input	USB-C
Volume control	+/- 6 dB
Battery power	3.7V LiPo battery pack
Battery life	8 hours (fully charged)
Charging	2 contacts for cradle charging
USB connection	Type C for charging and audio

Power	On/off switch
Registration	Push button for registration with Access Link
Dimensions (L x W x H)	2.9" x 1.1" x 0.7" (74 x 28 x 18mm)
Weight	1.2 oz (34g)

SHAREMIKE

Description	Handheld transceiver
Wireless communication	Access Technology (1.9 GHz)
Audio distortion	<1%
Integrated microphone	Uni-directional electret
Audio input	3.5mm
Battery power	3.7V LiPo battery pack
Battery life	8 hours (fully charged)
Charging	2 contacts for cradle charging
Power	On/off button
Registration	Push button for registration with Access Link
Dimensions (L x W x H)	6.0" x 1.1" x 1.1" (153 x 28 x 28mm)
Weight	2.6 oz (73g)

MEDIA CONNECTOR

Description	Wireless audio transceiver
USB power	5V USB-C connector
Wireless communication	Access Technology (1.9 GHz)
Tone control	1 bass/treble control
Audio input	3.5mm stereo (x4) with master volume
Audio output	3.5mm stereo (X2) mixed with volume control
Audio Link indicator	1 LED on front panel
Device registration	Push button for Access Link
Dimensions (W x H x D)	7.6" x 5" x 1.13" (193 x 127 x 29mm)
Weight	9.6 oz. (272g)