

975
POINT-TO-PAIR-3)

UConnect All Ears Soundfield and Voice Save Solutions



New Flexmike is 28% smaller & 33% lighter



The 975 ensures audio clarity of teachers, students and multimedia in any instructional space in the school.

It also works with your existing life-safety solutions to ensure building-wide communications are never missed...and can trigger alert notifications directly from the teacher's microphone.

Combined with Flexmike and speakers, 975 delivers the teacher's voice clearly throughout the classroom.

- Integrates with multimedia
- Simple controls, compact
- Add a second microphone for student sharing

Connect to any aid

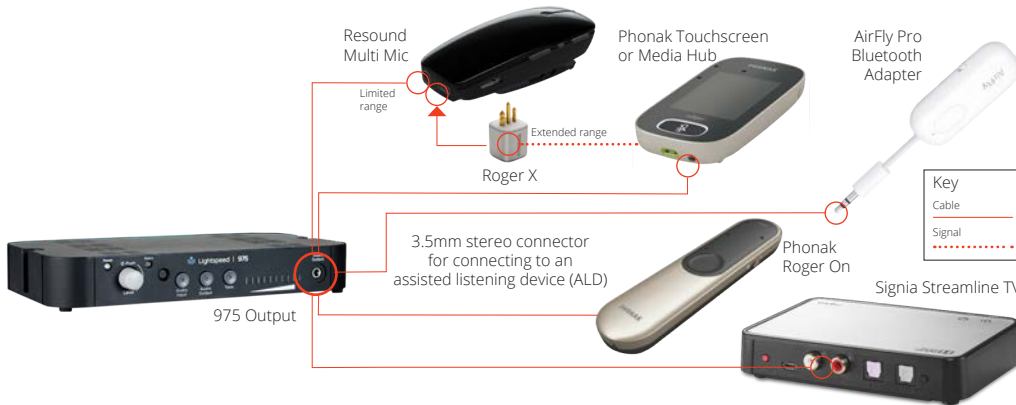

WHOLE CLASS SOLUTIONS

INSTALLED AUDIO SYSTEMS



975

UCONNECT SOUNDHOUSE AVAILABLE



...and overcomes physical barriers to listening.



Classroom noise



Distance



Hearing loss



Sore throat

975 INSTRUCTIONAL AUDIO SYSTEM



FRONT



BACK

Flexmike

PENDANT-STYLE WIRELESS MICROPHONE WITH CHARGER

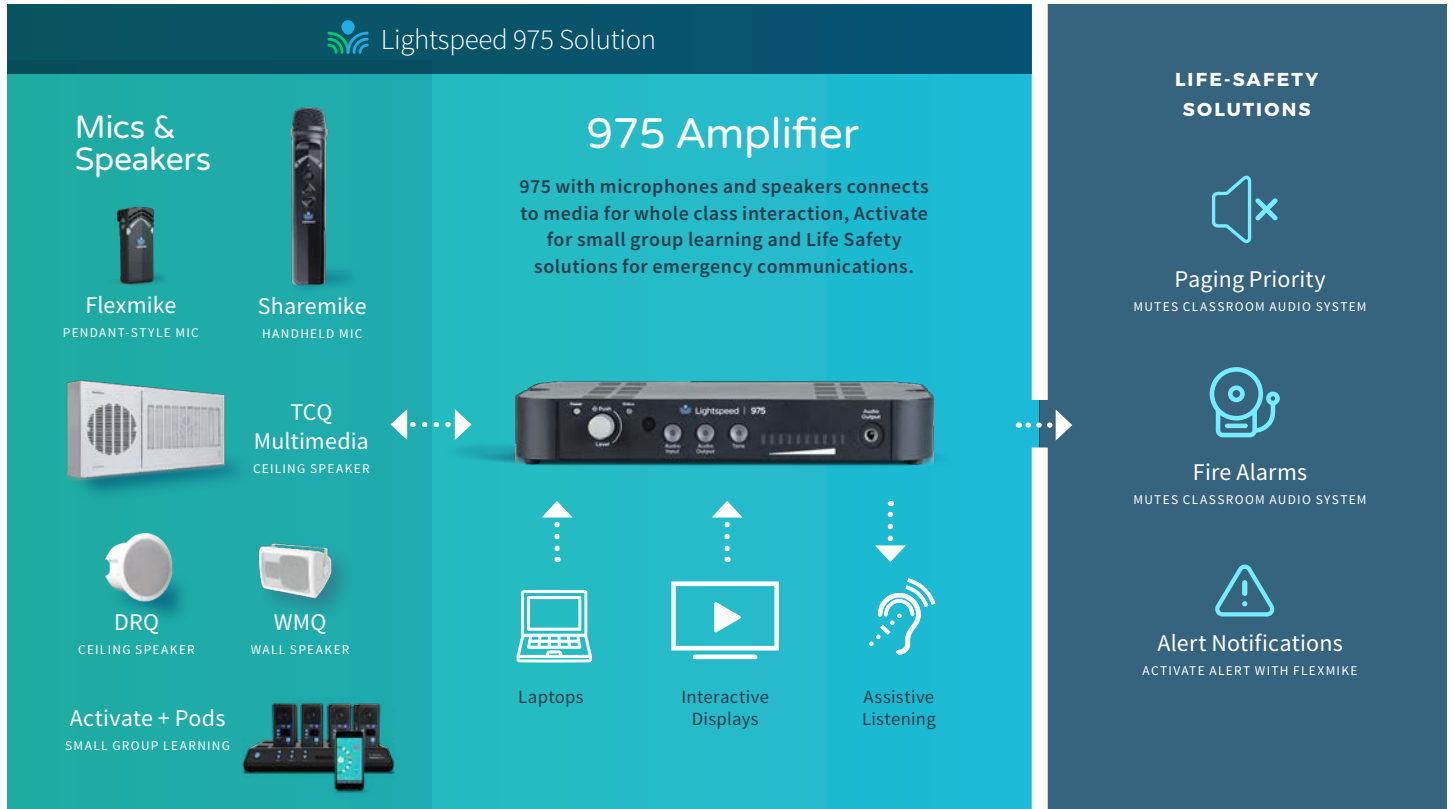

Specifications

Wireless Communication	Access Technology (1.9 GHz)
Wireless Transmission Range	Up to 200 ft. (60m) open field
Power Output	20 watts per channel (40 watts total)
Frequency Response	60 Hz - 7 kHz
Total Harmonic Distortion (THD)	<1% @ 10W
DC Power Input	24V/2.5A
Audio Input (with volume control)	Three 3.5mm inputs, one Toslink Digital Input
Audio Outputs	One 3.5mm Output
Tone Control	Bass / Treble
Life Safety Interface Connections	Inputs: PageFirst (25/70V page mute), relay mute Output: Contact closure (triggered from mic)
Dimensions (W x D x H)	7.6" x 5" x 1.13" (193 x 127 x 29mm)
Weight	9.5 oz (269g)

Features

- Multiple speaker options ensure high speech intelligibility in any instructional space
- Easily integrate all your audio sources and deliver high-quality audio for every student.
- Contact closure interface enables teacher to trigger an alert notification or other action through a third party system.
- Add Activate and Pods for small group learning, enabling teachers to interact with small groups